



7100 147th Street West
Apple Valley, MN 55124-9016

Telephone (952) 953-2588
www.cityofapplevalley.org

RESIDENTIAL FENCES

Fence Permits: Building permits are required for fences over seven feet in height. Fences under seven feet in height do not require a building permit but must meet the location and City ordinance requirements.

Fence Locations: All fences must be located entirely upon the private property owned by the person erecting the fence; including the concrete footing. The fence may be placed directly on the property line **if the adjoining property owner agrees in writing**. Generally, fences may be erected up to a height of eight feet in the rear and side yard areas. Maximum height in the front yard area is 3 ½ feet.

Pool fences: If the pool fence is constructed at the same time of pool installation, and a fence is required, then a separate fence permit is not required. If replacing a required pool fence, a fence permit will be required.

Maintenance: All fences must be constructed in a workman-like manner and be maintained in a reasonable state of repair so as not to become a hazard or nuisance.

ITEMS REQUIRED WITH THE PERMIT APPLICATION

Site plan: A survey showing the lot lines, location of the house and the proposed location of the fence must be submitted with the fence location drawn on it.

Drawings: A drawing or picture of the fence must be provided. Supply the location of the support posts.

Design: Fences over seven feet in height shall be designed by a licensed Structural Engineer or by a fence contractor. The design must meet the requirements of the State Building Code.

Agreements: If the fence will be located on the property line, **a written agreement with the owner of the adjoining property must be provided to the City.**

INSPECTIONS REQUIRED

- Footing Inspection:** A footing inspection is required for all fences that are over seven feet in height. **The owner or a surveyor must locate the property line and the corner stakes shall be marked.**
- Final Inspection:** A final inspection should be scheduled after the fence is complete.

ILLUSTRATION OF ALLOWABLE FENCE LOCATIONS AND HEIGHTS

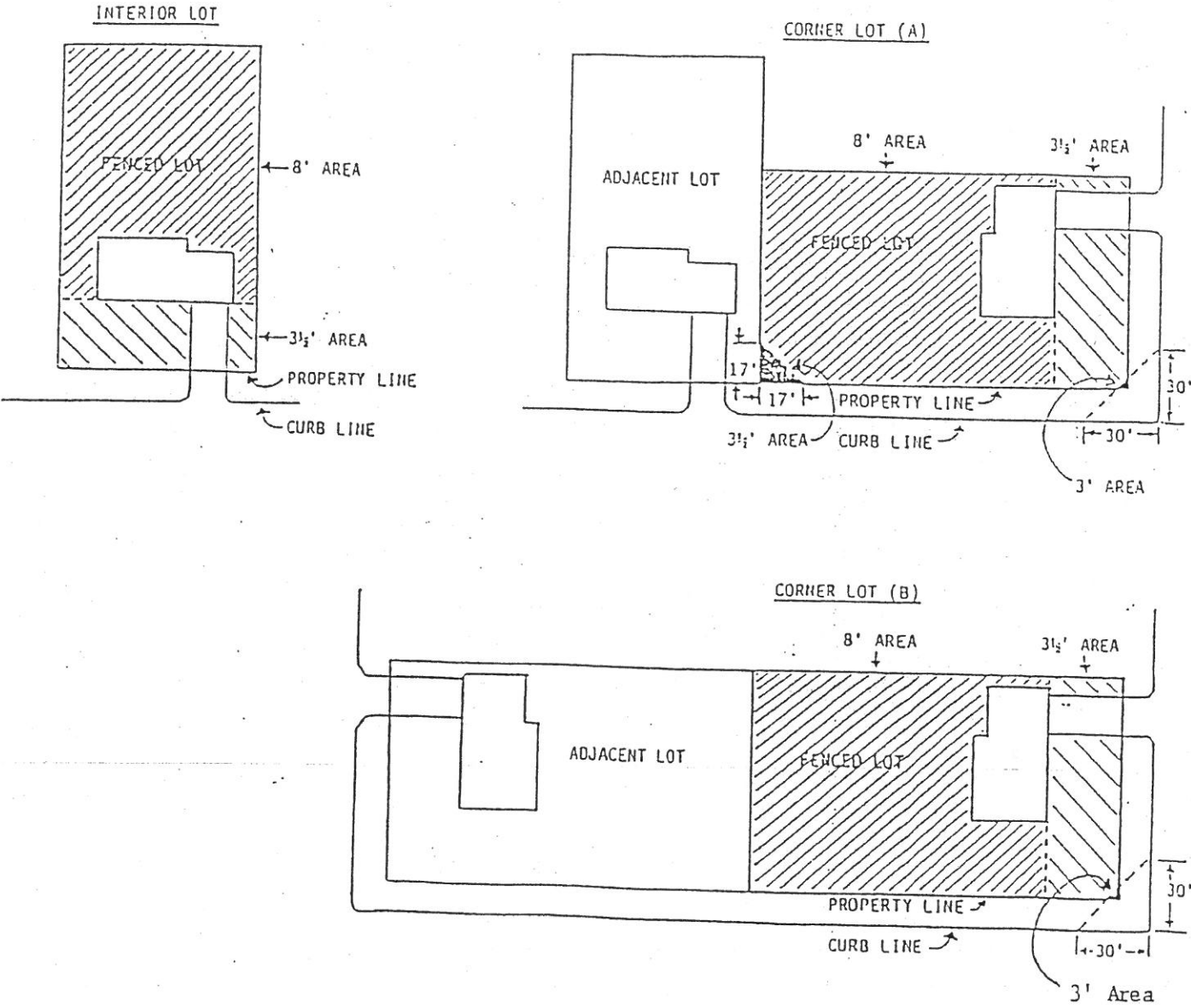

This handout is written as a guide to the most common questions and problems and is not intended nor shall it be considered a complete set of requirements.